

FINEST QUALITY

Union Special®
LEWIS • COLUMBIA

**INDUSTRIAL
SEWING
MACHINES**

CLASS

51000

LIST OF PARTS

FOR

STYLE 51000 G

**CATALOG
NO.**

T119 L

Union Special **CORPORATION**

CHICAGO

From the library of: Superior Sewing Machine & Supply LLC

Catalog No. T119 L

LIST OF PARTS

Style

51000 G

First Edition

Copyright 1960

By

Union Special Corporation
Rights Reserved in All Countries

Union Special
CORPORATION
INDUSTRIAL SEWING MACHINES
CHICAGO

October , 1974

Printed in U.S.A.

IDENTIFICATION OF MACHINES

Each Union Special machine is identified by a Style number which is stamped into the name plate.

Machines similar in construction are designated by a Class number which contains no letters. Letters suffixed to the Class number indicate the individual Standard machine style. Letter "Z", however, is reserved as a suffix to the Standard style identification to specify machine is of Special construction.

APPLICATION OF CATALOG

This catalog applies specifically to the Standard style of machine as listed herein. It can also be applied with discretion to some Special machines in this Class. References to direction such as right, left, front, back, etc., are given from the operator's position while seated at the machine.

IDENTIFYING PARTS

Where construction permits, each Union Special part is stamped with its catalog number. A part too small for its complete catalog stamping is identified by a letter symbol which distinguishes it from another part similar in appearance.

Each part number represents the same part regardless of catalog in which it appears.

IMPORTANT! ON ALL ORDERS, PLEASE INCLUDE PART NAME AND STYLE OF MACHINE FOR WHICH PART IS ORDERED.

TERMS

Prices are strictly net cash and are subject to change without notice. All shipments are forwarded at the buyer's risk f.o.b. shipping point. Parcel Post shipments are insured unless otherwise directed. A charge is made to cover the postage and insurance.

NEEDLES

Each Union Special needle has both a type number and a size number. The type number denotes the kind of a shank, point, length, groove, finish, and other details. The size number, stamped on the needle shank, denotes the largest diameter of the blade measured in thousandths of an inch midway between the shank and the eye. Collectively, type number and size number represent the complete symbol.

Selection of proper needle size should be determined by the size of the thread used. Thread should pass freely through the needle eye in order to produce a good stitch formation.

For best results, use only genuine Union Special needles in the operation of this machine. They are packaged under our brand name, *Union Special* which is backed by a reputation for producing highest quality needles for more than three-quarters of a century.

NEEDLES (Continued)

To have needle orders promptly and accurately filled, forward a sample needle, the empty package, or description on label. A complete order would read as follows: "1000 Needles, Type 108GS, Size 044".

| Type No. | Description and Sizes |
|-------------|---|
| 108GS | Round shank, round point, extra short, double groove, ball eye, spotted, struck groove, chromium plated - sizes 032, 036, 040, 044, 049, 054. |

Standard needle for Style 51000 G is Type 108GS in size 036.

OILING

The oil has been drained from the machine before shipping, and the reservoir must be filled before beginning to operate. Use a straight mineral oil with a Saybolt viscosity of 90 to 125 seconds at 100° Fahrenheit.

Oil is filled at the spring cap on the top cover, left hand side, and the oil level is checked at the sight gauge, on the lower left hand corner, on front of the machine. The oil level should be maintained between the red lines on the gauge. Capacity of the reservoir is twelve ounces.

Machine is automatically lubricated and no oiling other than keeping the main reservoir filled is necessary.

A daily check before the morning start should be made. Add oil if required to maintain suggested level.

Oil which has passed through the machine is filtered and pumped back into the main reservoir making a too frequent oiling unnecessary.

Excessive oil in the main reservoir may be drained at the plug screw, in the main frame, directly under the handwheel.

DESCRIPTION OF MACHINES

Taupe Finish, Left Hand, Single Needle, Low Throw, Flat Bed Machine. 5/8 Inch Looper Travel, Light Weight Presser Bar and Needle Bar Drive, Oil Return Pump and Siphon Assembly.

51000 G For miscellaneous light weight seaming and hemming. Can also be used in conjunction with a right hand machine for simultaneously hemming both sides of towels, handkerchiefs, sheets, light weight bags and similar articles using customer's attachments. Seam Specification 401-SSa-1. Stitch range 10 to 16 per inch.

The following is a numerical list of the parts used in this machine. Quantities, part numbers, and descriptions are given. Following the parts list are photographs of some of the major parts.

| Amt. | Part No. | Description | Amt. | Part No. | Description | Amt. | Part No. | Description |
|------|------------|---|------|----------|---|------|----------|---|
| 1 | 8 | Feed Rocker Shaft | 2 | 6042 A | Washer for 51035 A | 1 | 22852 A | Screw for 51042 B |
| 3 | 18 | Nut for 51240 E, 51041 E, 55244 G | 1 | 11638 M | Nut for 51093 E | 1 | 22863 | Adjusting Screw for 56334 E |
| 1 | 20 | Washer for 539, 51236 G | 1 | 12538 | Nut for 51041 G | 1 | 22883 A | Plug Screw for lpr. drive shaft hole |
| 2 | 25 | Screw for 51003 G | 1 | 12982 | Lock Nut for 81 | 4 | 22894 C | Set Screw for lpr. drive eccentric |
| 1 | 27-435 | Washer for 51258 A | 1 | 15465 F | Looper Rocker Cone (88) | 1 | 22894 D | Spot Screw for lpr. drive eccentric |
| 2 | Blk. 28 | Screw for 52804 A | 1 | 21210 A | Looper Collar | 2 | 22894 D | Spot Screw for 29476 DV, DX |
| 2 | 50-216 | Pin for 51057 G | 1 | 21212 | Oil Siphon Conn. Locking Ring for 51294 Z | 2 | 22894 F | Set Screw for 51221 C |
| 1 | 50-458 | Pin for 56341 G | 1 | 21657 E | Washer for 51057 G | 1 | 22894 H | Screw for 51042 C |
| 2 | 52 A | Frame Thread Eyelet (98 A) | 1 | 21657 Z | Tension Release Shaft Bushing | 1 | 22894 J | Set Screw for 51247 |
| 1 | 56 | Needle Clamp Nut | 2 | 22503 F | Screw for bed | 1 | 29066 R | Needle Lever Ball Joint, upper (22559 G) |
| 1 | 73 | Screw for looper | 3 | 22513 | Screw for 35731 A | 1 | 29105 AA | Looper Drive Eccentric Assembly |
| 1 | 77 | Screw for 51054 | 1 | 22513 | Screw for 51070 G | 1 | 29192 J | Looper Rocker Assembly |
| 2 | 77 | Screw for 51034, 51035 A | 1 | 22519 H | Screw for 51244 B | 1 | 29348 W | Needle Lever Assembly |
| 2 | 80 | Screw for 51001 G | 7 | 22524 | Screw for 51082 C | 1 | 29476 DV | Looper Avoid Eccentric Assembly (22894 D) |
| 1 | 81 | Screw for 51042 B | 1 | 22528 | Screw for 51005 G | 1 | 29476 DX | Feed Lift Eccentric Assembly (22894 D) |
| 1 | 82 | Stitch Regulating Screw | 1 | 22528 | Screw for 51057 G | 1 | 29476 KG | Crankshaft Assembly |
| 2 | 88 | Screw for 15465 F | 1 | 22539 | Screw for 51001 G | 6 | 35178 D | Spring for 666-65, 666-114 |
| 8 | 90 | Screw for 51082 P | 2 | 22539 A | Plug Screw for bed Screw for 51083 | 2 | 35731 A | Presser Bar Guide Plate (22513, 22729 D) |
| 3 | 90 | Screw for 52894 AB | 1 | 22557 | Bearing Cap Screw for 29105 AA, lower | 3 | 35772 H | Washer for 51081 H |
| 1 | 91 | Screw for 51030 G | 2 | 22559 A | Bearing Cap Screw for 29105 AA, upper | 1 | 35853 V | Pin for 51041 G |
| 2 | 95 | Screw for 51147 | 1 | 22559 B | Screw for 29066 R | 2 | 41071 G | Nut for 51294 P |
| 1 | 96 | Spot Screw for 51723 A | 1 | 22559 G | Screw for 29066 R | 2 | 41394 A | Gasket for 22733 B |
| 1 | 96 | Screw for 51044 | 1 | 22560 B | Screw for feed bar shaft | 1 | 43232 R | Spring Washer for 51083 |
| 2 | 97 A | Screw for 51041 G | 2 | 22560 B | Screw for 51051 | 1 | 51001 G | Cloth Plate (80, 22807, 22839) |
| 1 | 98 | Screw for 482 | 2 | 22560 B | Screw for 51493 BP | 1 | 51003 G | Edge Guide (25) |
| 1 | 98 | Screw for 51044 | 1 | 22562 A | Screw for 51154 G | 1 | 51005 G | Feed Dog (22528) |
| 2 | 98 A | Screw for 52 A | 1 | 22564 | Screw for 51054 | 1 | 51008 G | Looper (73, 21210 A) |
| 4 | 109 | Tension Disc | 3 | 22569 B | Screw for 51493 AG | 1 | 51013 | Looper Rocker marked "L" |
| 2 | 187 A | Screw for 51082 L | 3 | 22569 B | Screw for main shaft housing | 1 | 51015 G | Needle Lever for 29348 W |
| 1 | 258 | Nut for 56334 E | 2 | 22570 | Screw for 51024 G | 1 | 51020 G | Presser Foot Assembly |
| 1 | 258 A | Lock Nut for 51745 | 18 | 22571 A | Plug Screw for bed | 1 | 51022 G | Main Shaft |
| 2 | 269 | Nut for 51240 E, 51236 G | 1 | 22571 B | Plug Screw | 1 | 51024 G | Throat Plate (22570) |
| 2 | 402 | Screw for 51051, 51083 | 1 | 22580 D | Set Screw for 51723 A | 1 | 51025 A | Needle Guard (22585 B, 22801) |
| 2 | 482 | Collar for 8 (98) | 2 | 22585 A | Screw for 51082 C | 1 | 51030 G | Shank for 51020 G(91) |
| 2 | 531 | Screw for 51493 BQ | 1 | 22585 B | Screw for 51025 A | 1 | 51030 H | Presser Foot Bottom (22799 G) |
| 1 | 538 | Feed Dog Height Adjusting Screw | 1 | 22586 R | Screw for 51250 E | 1 | 51030 J | Yielding Section for 51020 G |
| 1 | 539 | Needle Thd. Eyelet (20, 22848) | 1 | 22706 A | Plug Screw for bed | 1 | 51030 K | Spring for 51020 G (604) |
| 1 | 604 | Screw for 51030 K | 1 | 22729 | Screw for 51243 C | 1 | 51034 | Feed Bar (77, 258, 538, 22560 B, 22863) |
| 1 | 643-127 | Pump Housing | 1 | 22729 A | Screw for 51294 P | 1 | 51035 | Feed Rocker (92127) |
| 1 | Blk. | Gasket | 1 | 22729 B | Screw for 51294 K | 1 | 51035 A | Feed Rocker Arm (77, 6042 A, 55235 D, 55235 E) |
| 1 | 660-169 | Needle Bearing for 51236 E | 2 | 22729 C | Screw for 51041 E | 1 | 51041 E | Looper Connecting Rod Ball Joint, right (18, 97 A) |
| 1 | 660-196 | Needle Bearing for 51145 A | 1 | 22729 C | Screw for 51041 G | 1 | 51041 G | Looper Connecting Rod and Ball Joint Assembly, left (12538, 22729 C) |
| 1 | 660-202 | "O" Ring for 51221 C | 2 | 22729 D | Screw for 35731 A | 1 | 51042 A | Looper Drive Lever Shaft |
| 2 | 660-212 | Oil Seal Ring for 51250 E, (22586 R) | 1 | 22733 B | Plug Screw for 51082 K (41394 A) | | | |
| 2 | 660-310 | Retaining Ring for 35853 V | 1 | 22737 | Screw for 51082 D | | | |
| 2 | 666-65 | Oil Wick for looper rock shaft | 3 | 22760 A | Screw for 51081 H | | | |
| 1 | 666-97 | Oil Sight Gauge | 2 | 22768 | Screw for 51236 B | | | |
| 1 | 666-98 | Oil Cup for 51082 N | 2 | 22768 | Screw for 56358, 56358 A | | | |
| 2 | 666-111 | Oil Wick for feed rocker shaft | 1 | 22768 | Screw for 51244 B | | | |
| 4 | 666-114 | Oil Wick for main shaft | 1 | 22799 G | Hinge Screw for 51030 H | | | |
| 1 | 666-170 | Oil Wick for 51250 E | 1 | 22801 | Stud Screw for 51025 A | | | |
| 2 | 666-179 | Wedge Pin for 666-111 | 1 | 22807 | Screw for 51001 G | | | |
| 1 | 666-201 | Felt Plug for 51294 U | 1 | 22811 B | Screw for 51042 C | | | |
| 1 | 666-209 | Felt Disc for 51294 U | 1 | 22829 | Screw for 15465 F, 51745 | | | |
| 1 | 666-214 | Felt Lint Tube for 51294 M | 1 | 22834 | Needle Guard Adjusting Screw | | | |
| 2 | 719 | Screw for 51250 E | 1 | 22837 | Screw for 51082 M | | | |
| | | | 8 | 22839 | Screw for 51001 G | | | |
| | | | 2 | 22839 | Screw for 51080 | | | |
| | | | 1 | 22840 | Eyelet Adapter Screw | | | |
| | | | 1 | 22845 B | Screw for 51081 H | | | |
| | | | 1 | 22848 | Screw for 539 | | | |
| | | | 8 | 22848 | Screw for 51082 K | | | |
| | | | 2 | 22849 | Screw for 51082 N | | | |

| Amt. | Part No. | Description | Amt. | Part No. | Description | Amt. | Part No. | Description |
|------|-----------------|--|------|-----------|---|------|----------|--|
| 1 | 51042 B | Looper Drive Lever Rocker (81, 12982, 22852 A, 51242 M, 52841 G, 52841 H) | 2 | 51192 B | Tension Post Ferrule | 1 | 51294 M | Oil Tube |
| 1 | 51042 C | Looper Drive Lever (22811 B, 22894 H) | 2 | 51216 G | Needle Lever Connection Rod | 1 | 51294 P | Oil Tube Clamp for head oil siphon (22729, 41071 G) |
| 1 | 51044 | Looper Rocker Frame (96, 98) | 1 | 51216 J | Needle Lever Conn. Rod Bearing, lower | 1 | 51294 U | Oil Siphon Assembly |
| 1 | 51044 A | Looper Rocker Shaft | 28 | 51216 M | Needle Bearing Roller for 29476 KG | 1 | 51294 Z | Oil Tube Connection for head oil siphon |
| 1 | 51051 | Presser Bar Conn. (402, 22560 B) | 1 | 51216 N | Washer for 29066 R | 1 | 51306 | Feed Lift Eccentric, .072 inch throw, for 29476 DX (22894 D) |
| 1 | 51051 C | Presser Bar Bushing, lower | 1 | 51216 P | Washer for 55244 G | 1 | 51406 | Looper Avoid Ecc., .062 inch throw, for 29476 DV (22894 D) |
| 2 | 51054 | Needle Lever Link Pin (77, 22564) | 1 | 51217 C | Nut, left thread, for 29066 R | 2 | 51491 C | Lead-in Eyelet |
| 1 | 51054 | Feed Crank Link Pin (77) | 1 | 51221 C | Needle Bar (56) | 1 | 51493 D | Pump Driving Shaft |
| 1 | 51057 G | Cast-off Plate Support (21657 E, 22528) | 1 | 51225 W | Pulley (22894 F) | 2 | 51493 E | Shaft Driving Gear |
| 1 | 51070 G | Pull-up Wire (22513) | 2 | 51236 A | Washer for 22585 B Link Pin for 29476 DV, DX (77) | 1 | 51493 AG | Pump Housing (22569 B) |
| 1 | 51080 | Throat Plate Support (22839) | 1 | 51236 B | Feed Crank Stud Cap (22768) | 1 | 51493 AH | Pump Housing Cover (22569 B) |
| 1 | 51081 G- 207 | Cloth Plate Cover | 1 | 51236 D | Feed Crank Link | 1 | 51493 BK | Lint Filter Screen |
| 1 | 51081 H | Cloth Plate Cover Spring (22760 A, 22845 B, 35772 H) | 1 | 51236 E | Feed Crank Link Assembly (660-169) | 1 | 51493 BP | Oil Pump Driving Gear (22560 B) |
| 1 | 51082 C | Oil Reservoir Top Cover (22524, 22585 A) | 1 | 51236 F | Ferrule for 51236 E | 1 | 51493 BQ | Oil Pump Driven Gear (531) |
| 1 | 51082 D | Drip Plate for 51082 C (22737) | 1 | 51236 G | Feed Crank Stud (20, 269, 82) | 1 | 51723 A | Take-up (96, 22580 D) |
| 1 | 51082 K | Oil Reservoir Back Cover (22733 B, 22848) | 1 | 51240 E | Lpr. Conn. Rod (18, 269) | 1 | 51745 | Looper Rocker Cone Stud (258 A, 22829) |
| 1 | 51082 L | Oil Drip Plate (187 A) | 2 | 51242 L | Thrust Washer for 51042 B | 1 | 52804 A | Cast-off Plate (28) |
| 1 | 51082 M | Head Cover (22837) | 1 | 51242 M | Washer for 51042 B (52841 G) | 1 | 52841 G | Locking Stud for 51042 B |
| 1 | 51082 N | Top Cover (22849) | 1 | 51242 R | Looper Drive Shaft Bushing, center | 1 | 52841 J | Nut for 52841 G |
| 2 | 51082 P | Chamber Cover | 1 | 51242 S | Looper Drive Shaft Bushing, rear | 1 | 52882 E | Top Cover Gasket |
| 1 | 51083 | Hand Lift Lever (402, 22557, 43232 R) | 1 | 51242 Z | Looper Drive Shaft Bushing, front | 1 | 52889 | Presser Bar Bushing, upper |
| 1 | 51093 E | Feed Crank Oil Tube (11638 M) | 1 | 51243 C | Ball Stud Fork (22729) | 2 | 52890 C | Main Shaft Bushing, right and middle |
| 1 | 51094 G | Feed Lift Ecc. Oil Tube | 1 | 51244 B | Looper Rocker Shaft Arm (22519 H, 22768) | 1 | 52891 B | Main Shaft Housing and Bushing (22569 B, 56390 E) |
| 1 | 51094 H | Oil Tube Assembly | 2 | 51244 L | Thrust Washer for 51044 A | 3 | 52894 AB | Oil Tube Holder (90) |
| 1 | 51134 C | Feed Bar Shaft | 1 | 51244 N | Looper Rocker Shaft Collar (18, 51216 N, 55244 G) | 2 | 52936 | Feed Rocker Shaft Bushing |
| 1 | 51134 J | Washer for 56334 E | 1 | 51246 | Looper Rocker Stud Nut | 1 | 52944 T | Looper Rocker Shaft Bushing, right |
| 1 | 51134 P | Lubricating Felt for feed rocker shaft | 1 | 51247 | Main Shaft Counter- weight (22894 J) | 1 | 52944 U | Looper Rocker Shaft Bushing, left |
| 1 | 51134 R | Lubricating Felt Guard | 1 | 51250 D | Washer for 51250 E | 1 | 52994 L | Looper Avoid Ecc. Oil Tube |
| 1 | 51145 A | Eccentric Link Assembly for 29476 DV, DX | 1 | 51250 E | Needle Lever Stud (666-170, 719) | 2 | 55235 D | Screw for 51035 A |
| 1 | 51147 | Main Shaft Thrust Collar (95) | 1 | 51250 F | Gasket for 51250 E | 2 | 55235 E | Nut for 51035 A |
| 1 | 51150 | Needle Lever Thrust Collar | 1 | 51257 K | Presser Bar | 1 | 55244 G | Looper Rock Shaft Collar Lock Stud (18, 51216 N) |
| 1 | 51154 C | Needle Bar Bushing, upper | 1 | 51282 M | Oil Reservoir Top Cover Gasket | 1 | 56334 E | Feed Dog Holder (258, 22863) |
| 1 | 51154 D | Needle Bar Bushing, lower | 1 | 51282 S | Oil Reservoir Back Cover Gasket | 1 | 56341 G | Spring for 51041 G |
| 1 | 51154 G | Needle Bar Conn. (22562 A) | 2 | 51282 U | Chamber Cov. Gasket | 1 | 56354 A | Needle Bar Connection Link for 29348 W |
| 1 | 51170 C | Pull-off Wire Support (22513, 51170 D) | 1 | 51290 T | Main Shaft Bushing, inner left | 1 | 56356 | Presser Spring Regulator |
| 1 | 51170 D | Nut for 51170 C | 2 | 51292 | Tension Post | 1 | 56358 | Needle Bar Thread Eyelet (22768) |
| | | | 2 | 51292 C | Tension Nut | 1 | 56358 A | Ndl. Lever Thread Eyelet (22768) |
| | | | 2 | 51292 D | Tension Eyelet | 1 | 56390 E | Gasket for 52891 B |
| | | | 1 | 51292 F-2 | Tension Spr. (lpr.) | 1 | 61256 | Presser Spring |
| | | | 1 | 51292 F-8 | Tension Spr. (ndl.) | 2 | 92127 | Screw for 51035 |
| | | | 1 | 51294 K | Upper Clamp for 51294 S (22729 B) | | | |

NOTE: Numbers in parentheses following parts description indicate the screws, nuts, etc., used to attach or hold these parts.

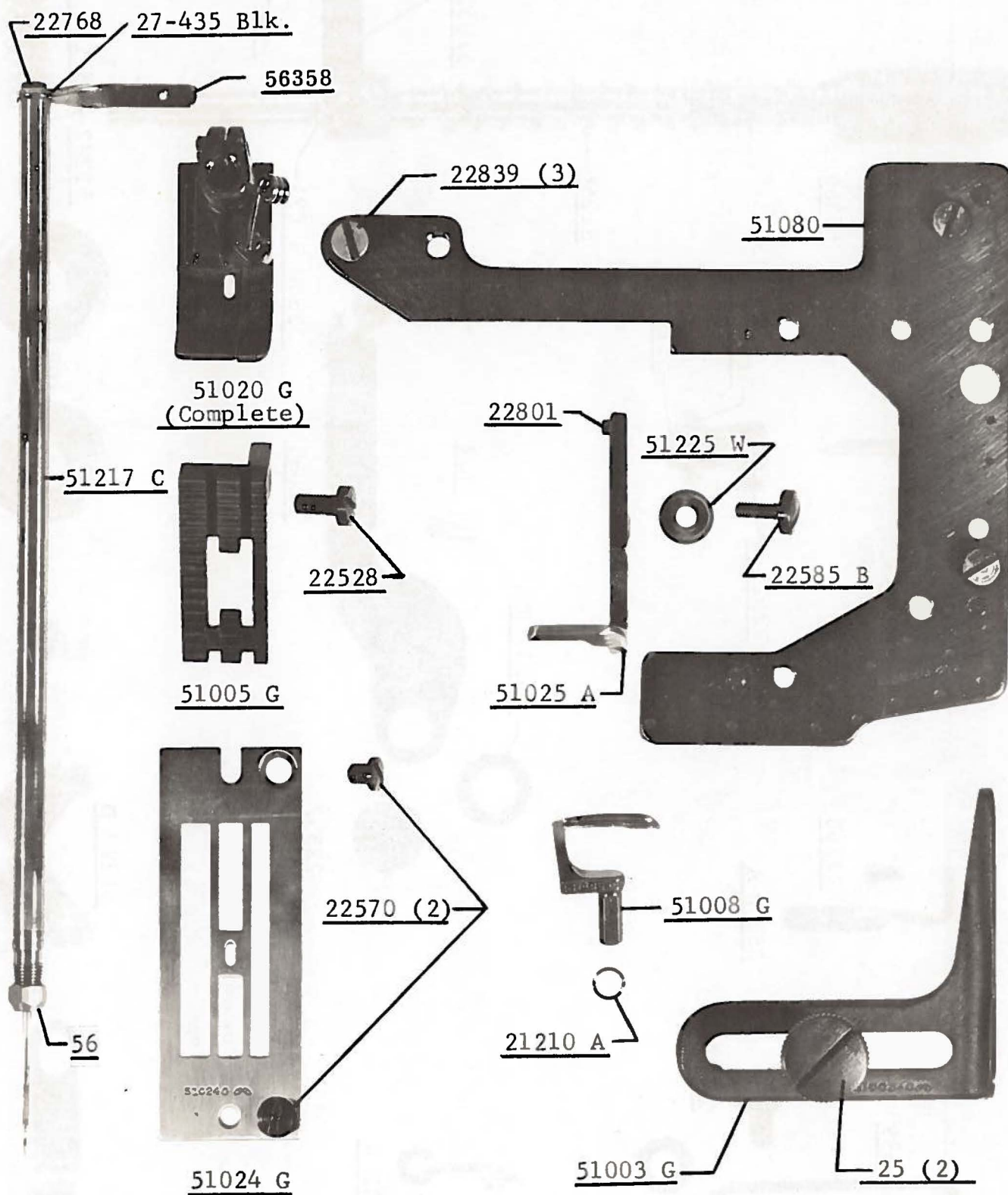

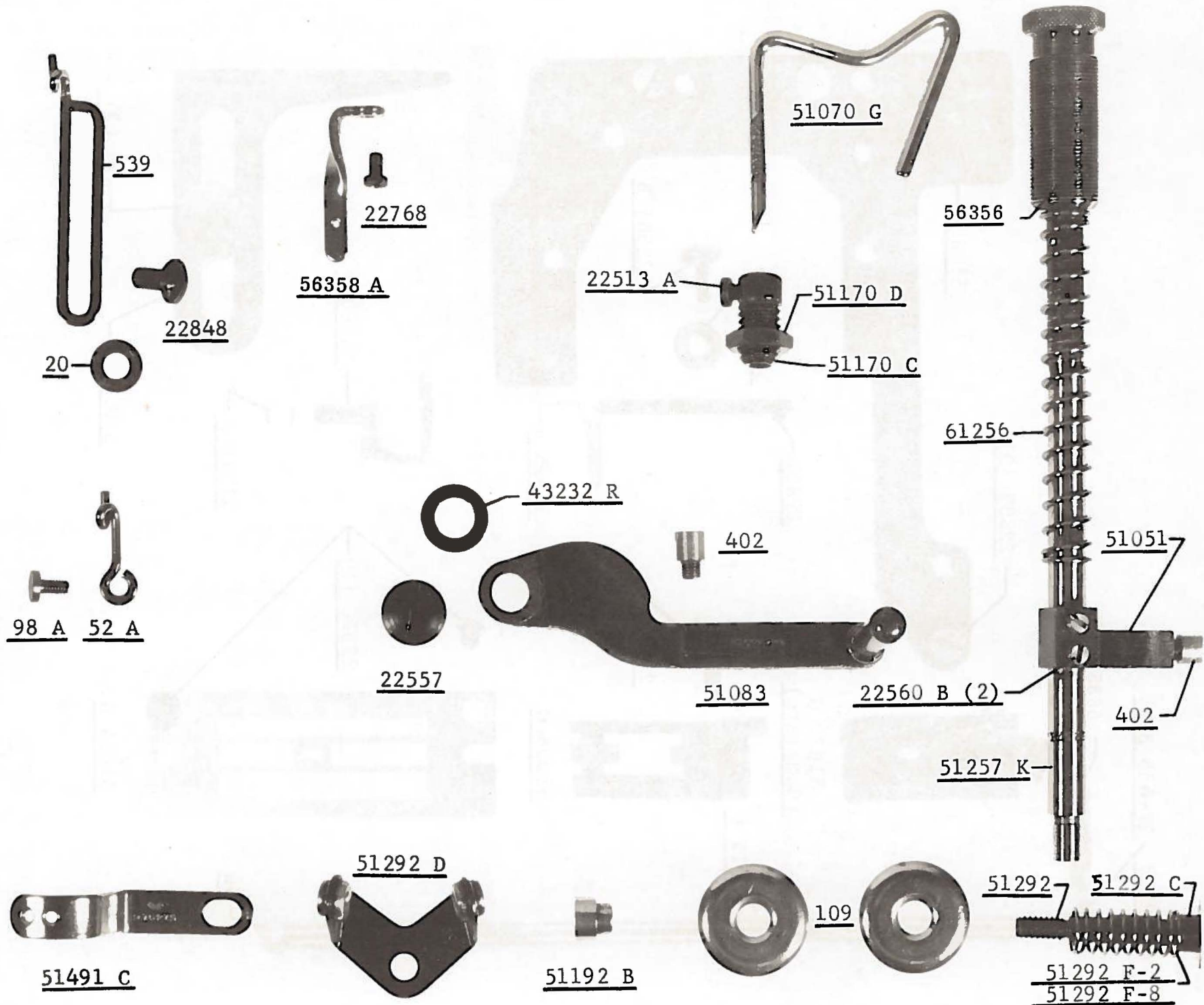

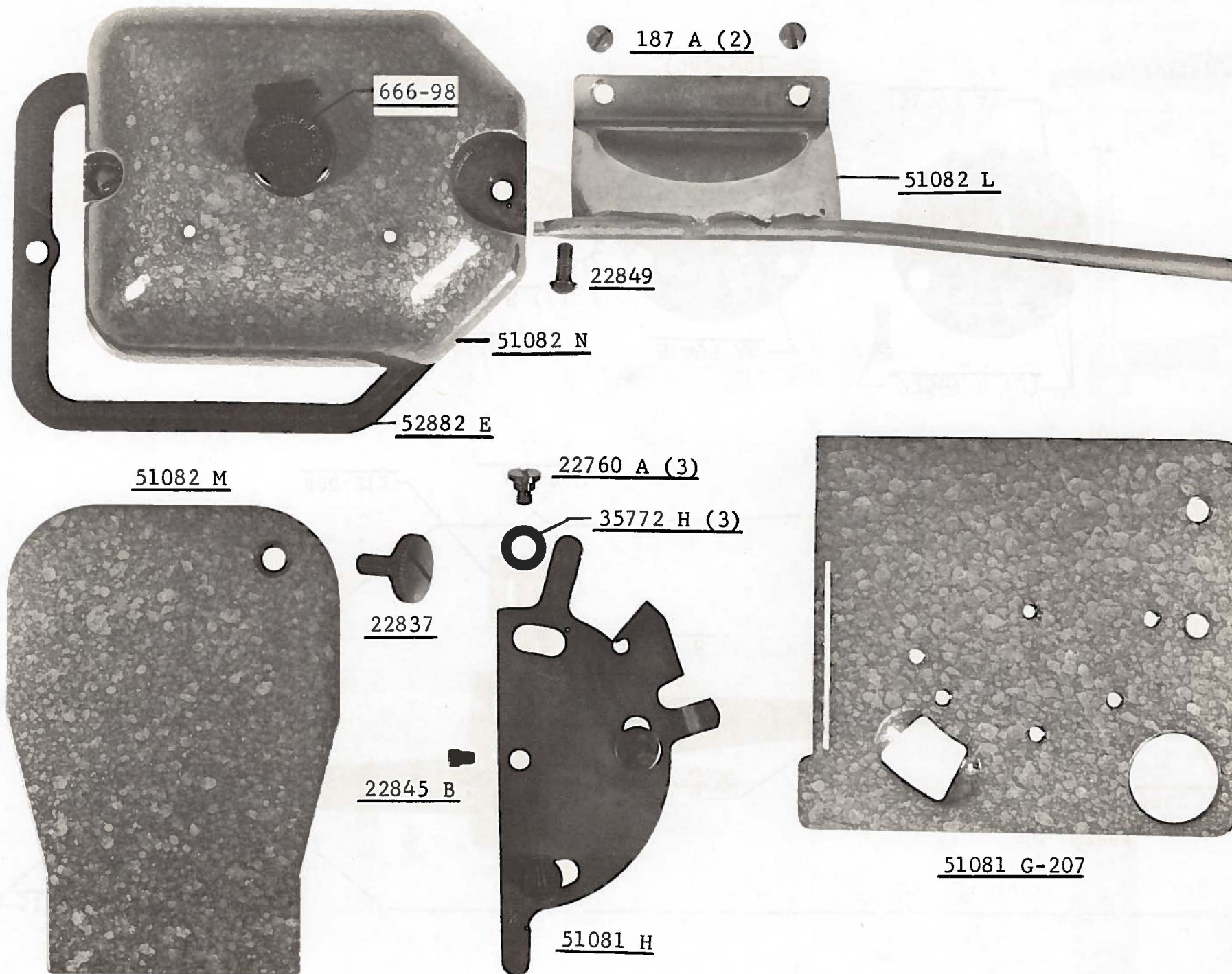

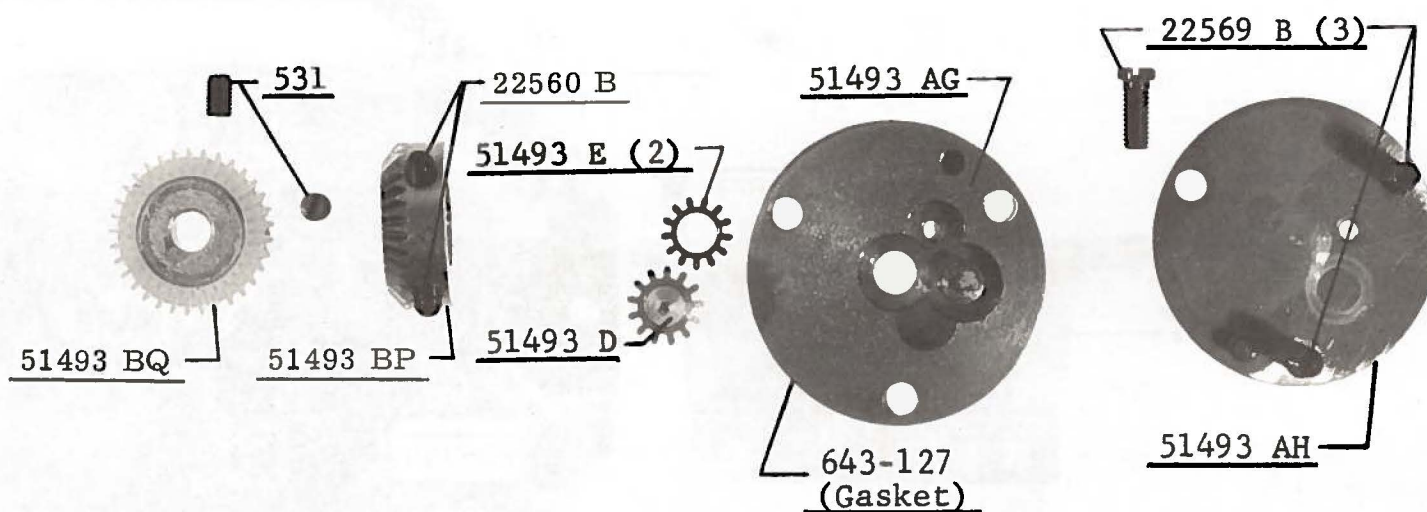
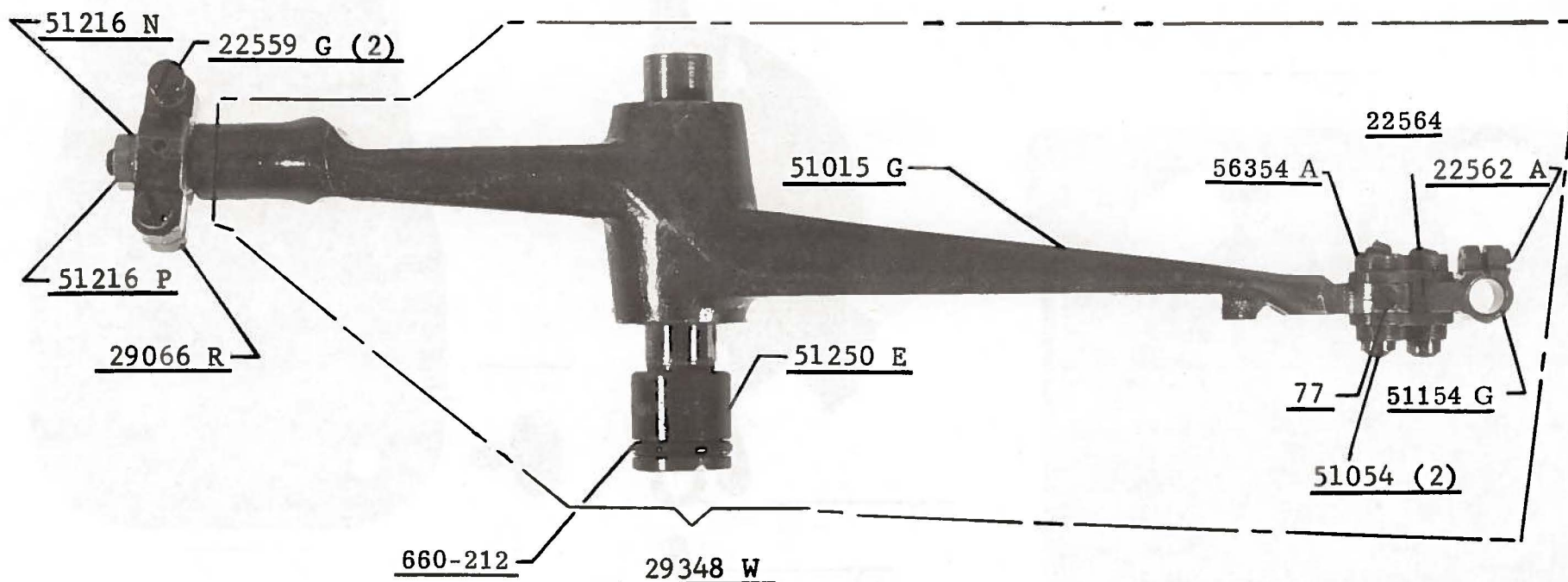

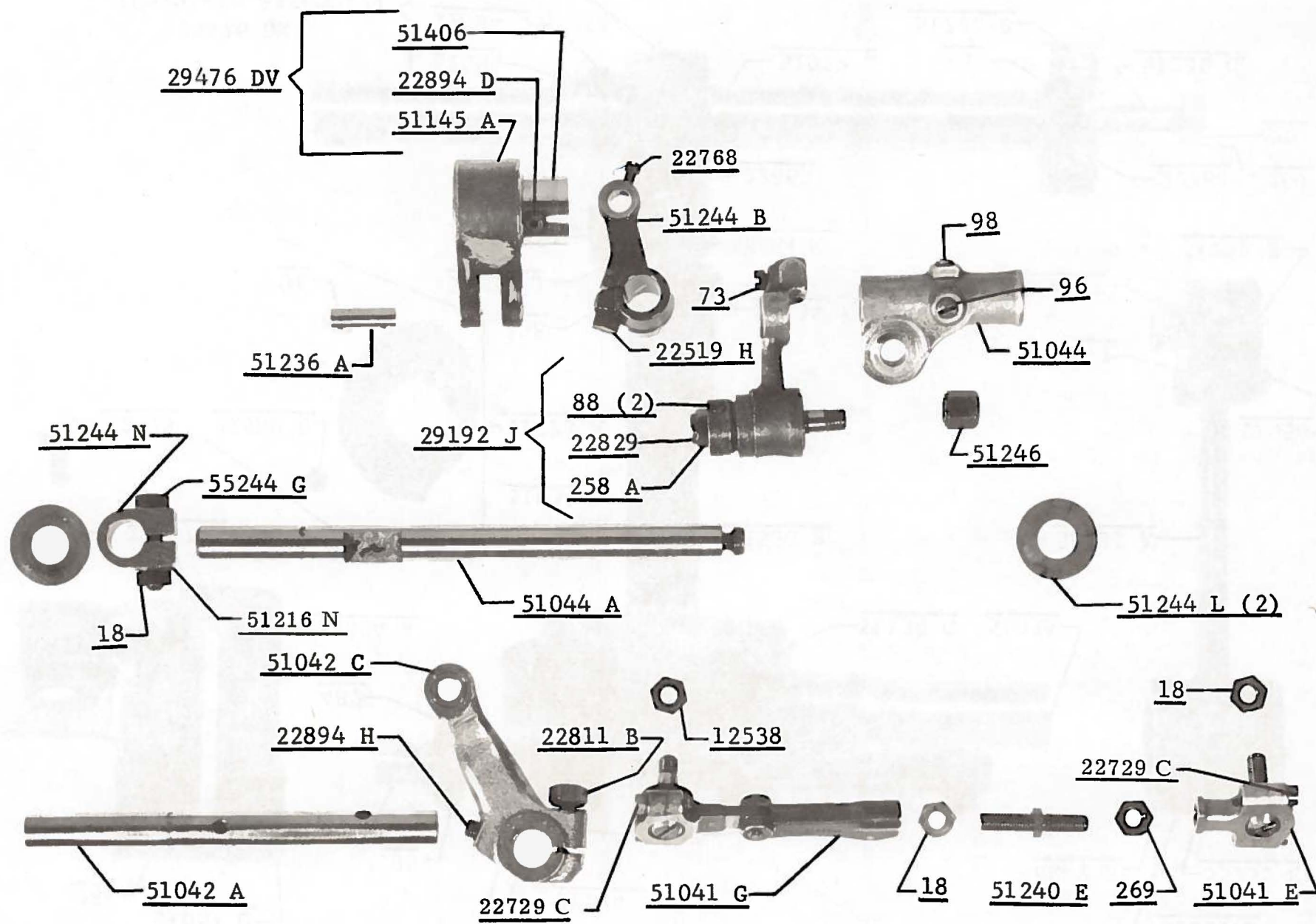

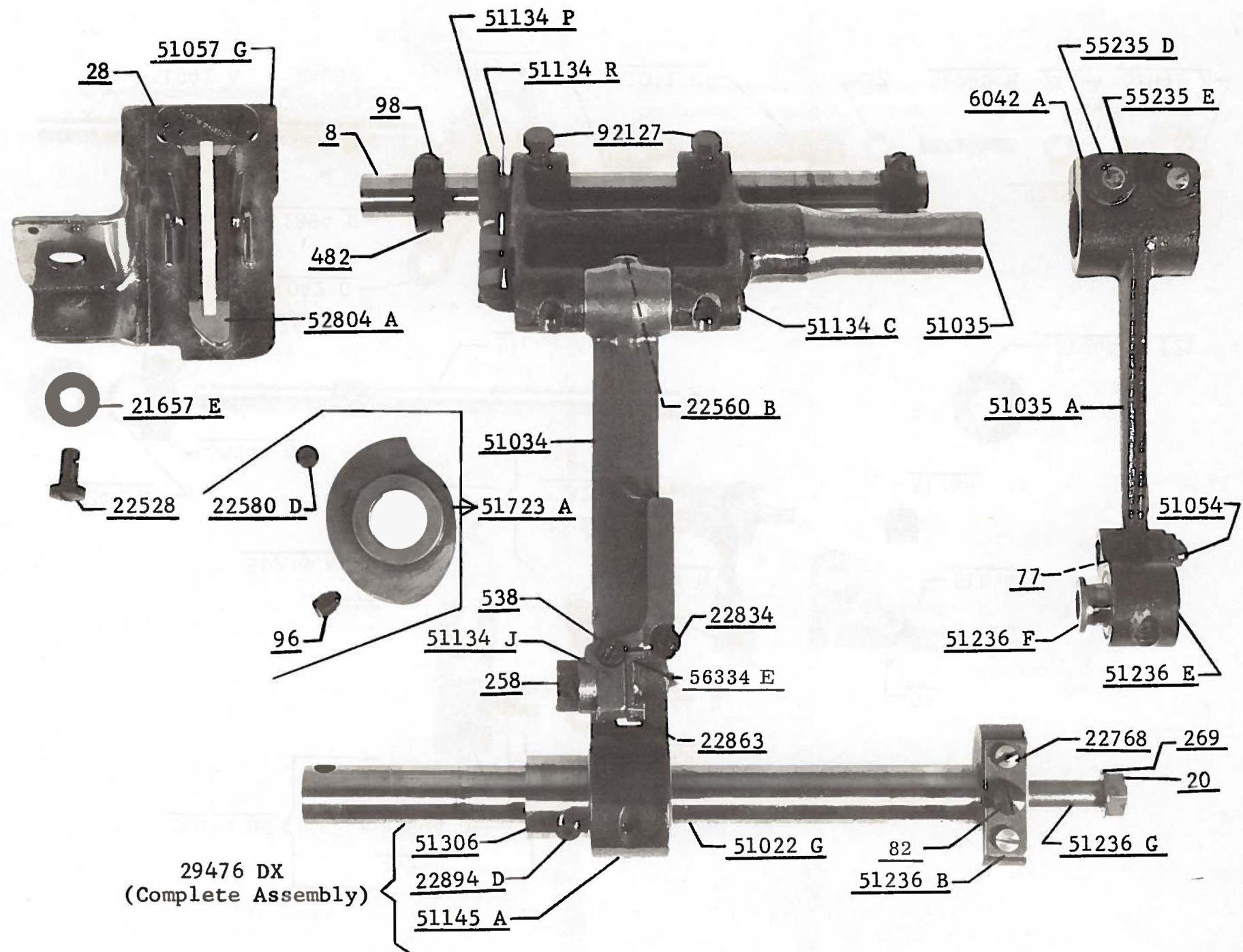

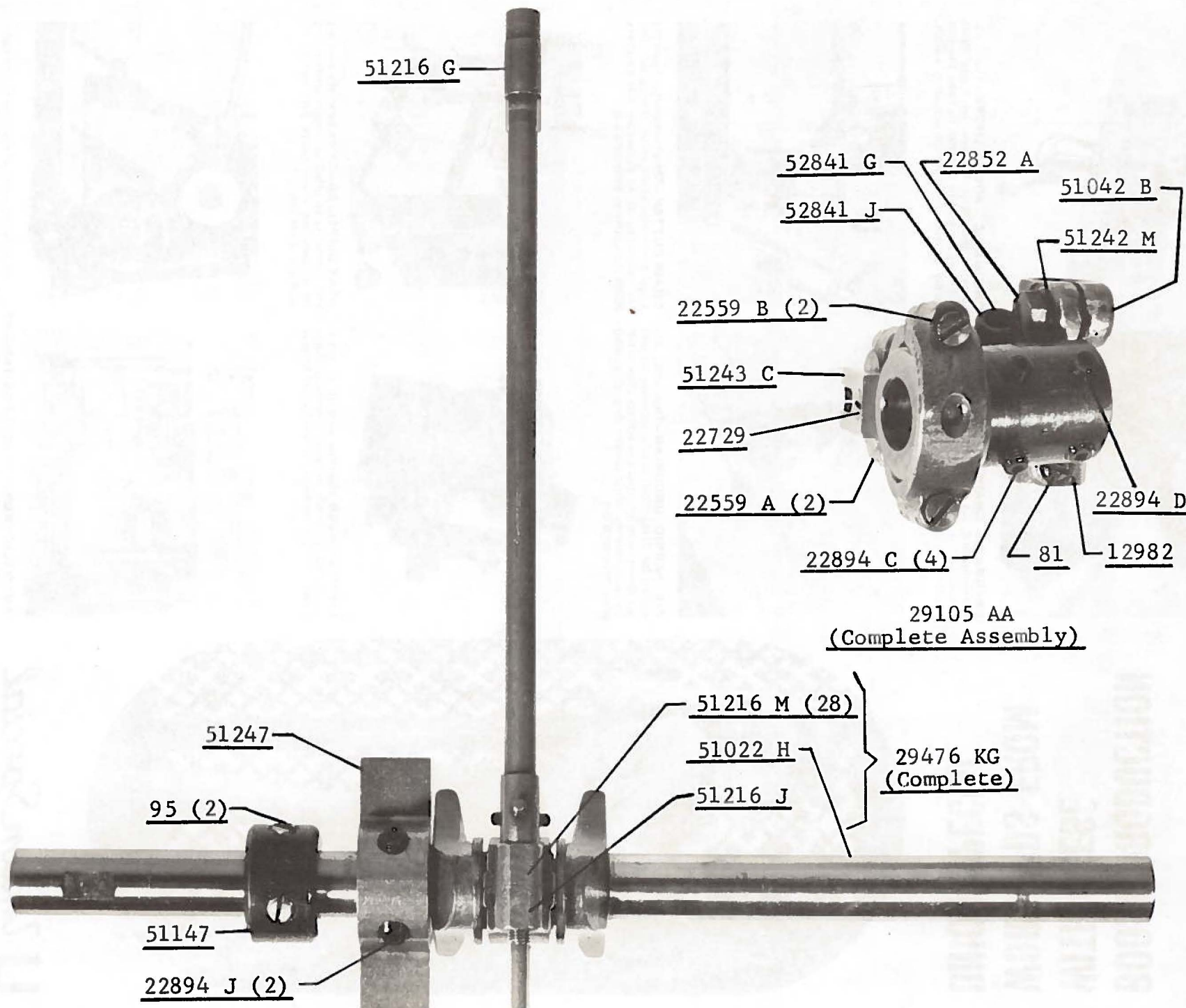

BOOST PRODUCTION WITH THESE WORK AIDS FROM UNION SPECIAL



Union Special[®]
FINEST QUALITY CORPORATION

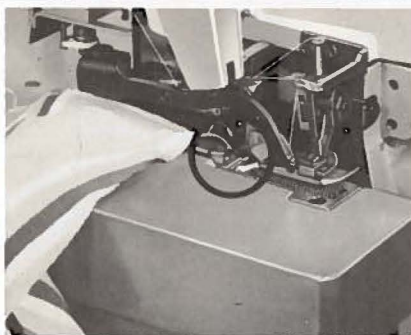

PNEUMATIC CHAIN-CUTTER—for use on conventional Class 39500 and 39600 is a durable scissor-action mechanism that makes a clean positive cut. Style 2899 A-1

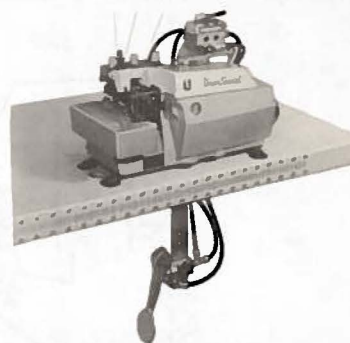

PNEUMATIC FOOT LIFTER—The air-operated foot lifter for use on Class 39500 machines allows the operator to raise the foot simply by knee-touching an actuating switch.

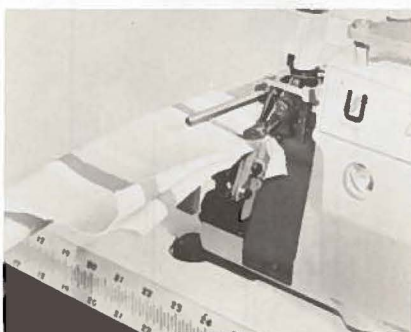

AIR FABRIC UNCURLER—This unit, designed for Class 39500 machines, uses air jets to remove curls from top and bottom plies of flat knit materials as fabric passes through sewing area. Style 2899 B-1

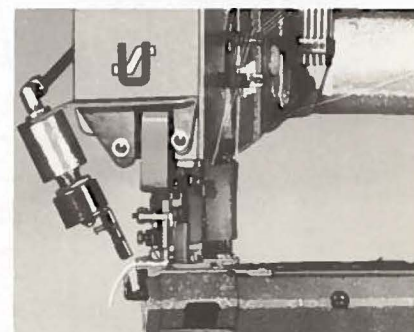

CHAIN CUTTER—The above photo shows the small pneumatic chain cutter that is available for installation as an accessory unit on Class 36200 Flatseamers. Style 2899 A-6

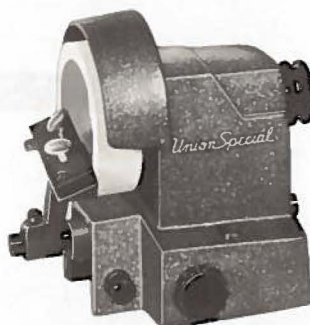

KNIFE GRINDER sharpens straight or angle type knives, is simple and easy to operate, eliminates defective garments caused by dull knives.



HEAT DISPELLER—Union Special's auxiliary unit (arrow) is an effective means for reducing oil temperature where heavy duty service requires it. Style 2899 E-1

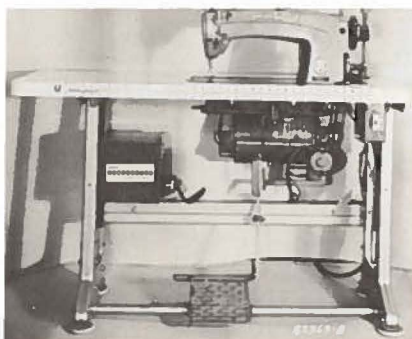

AMCO ELECTRONIC NEEDLE POSITIONERS eliminate the necessity of reaching for the hand-wheel to move the needle up or down . . . this allows the operator to keep both hands on the work, insuring better control, uniform quality and increased production.

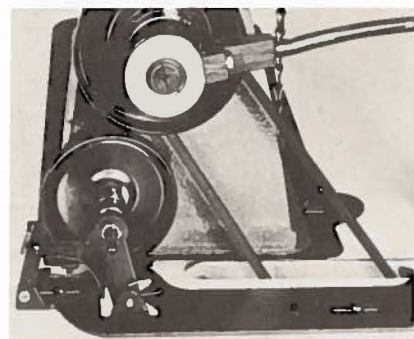

Helpful, authoritative information on the most efficient types of equipment for making virtually any machine sewed article is available from Union Special's Sales Promotion Department. Among the many interesting, illustrated bulletins that are available without obligation are the following:

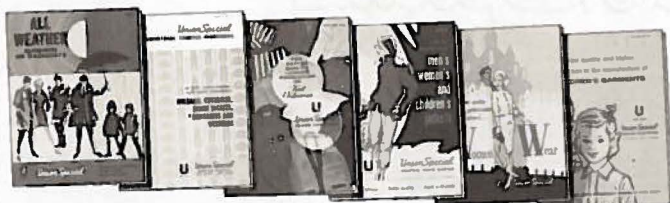

- No. 240, "Men's, Women's, Children's Footwear"
- No. 249, "Rainwear"
- No. 250, "Men's Dress Shirts"
- No. 251, "Service Shirts and Pants"
- No. 252, "Men's Shorts and Pajamas"
- No. 253, "Overalls, Coveralls, and Dungarees"
- No. 254, "Men's Knit Underwear"
- No. 256, "Knit Outerwear"
- No. 259, "Men's Sports Shirts"
- No. 260, "Work Gloves"
- No. 262, "Cotton, Burlap, Jute, and Multiwall Paper Bags"
- No. 263, "Men's Clothing"
- No. 264, "Men's Women's, Children's Jackets"
- No. 265, "Women's Wear"
- No. 266, "Women's Wear And High Fashion"
- No. 267, "Corsets, Girdles, Brassieres"
- No. 268, "Children's Wear"
- No. 269, "Mattresses, Slip Covers, Furniture Upholstery"
- No. 271, "Awnings, Canopies, Tents, Tarps"
- No. 273, "Curtains & Drapes"
- No. 610, "Klipp-it"
- No. 710, "MCS ForMation Unit"
- No. 730, "MCS Automatic Dual Underfront Shirt Hemmer"
- No. 740, "MCS Automatic Rib-Knit Cuff Machine"
- No. 750, "Fusing Presses"
- No. 1100, "Lewis Blindstitch, Chainstitch, Lockstitch, Machines"
- No. 1105, "Button Sewers—Ticket Tackers"
- "Columbia Blindstitch, Saddle Stitch, and Tie Closing Machines"
- No. 1500, "Alteration Department Machines"

 **Union Special**[®]
FINEST QUALITY
CORPORATION

**HERE ARE HELPFUL
BULLETINS and CATALOGS
TO HELP YOU SOLVE
SEWING PROBLEMS**





Union Special[®]
INDUSTRIAL SEWING MACHINES

UNION SPECIAL maintains sales and service facilities throughout the world. These offices will aid you in the selection of the right sewing equipment for your particular operation. Union Special representatives and service men are factory trained and are able to serve your needs promptly and efficiently. Whatever your location, there is a Union Special Representative to serve you. Check with him today.

ATLANTA, GA.

BOSTON, MASS.

CHICAGO, ILL.

DALLAS, TEXAS

LOS ANGELES, CAL.

NEW YORK, N. Y.

PHILADELPHIA, PA.

MONTREAL, CANADA

TORONTO, CANADA

BRUSSELS, BELGIUM

LEICESTER, ENGLAND

LONDON, ENGLAND

PARIS, FRANCE

STUTTGART, GERMANY

Representatives and distributors in all important
industrial cities throughout the world.

Union Special
CORPORATION

400 N. FRANKLIN ST., CHICAGO, ILL. 60610